

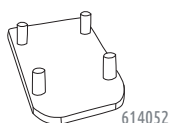

Oculto a cadena / Box rail chain system

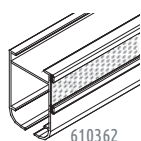

Perfil / Profile

| Ref. | Artículo / Article | Uni. | Datos / Data | Color | Mat. |
|--------|------------------------------------|--------|--------------|-----------|------|
| 610362 | Perfil Alhambra / Alhambra profile | 48m | 30x40mm | B Gr N Bg | Alum |
| 614052 | Tapa Alhambra / Alhambra end cap | 200 u. | 27x40mm | B Gr N Bg | POM |

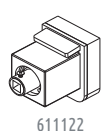
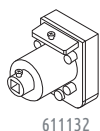
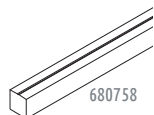

Sistema eje cuadrado / Square axis system

| Ref. | Artículo / Article | Uni. | Datos / Data | Color | Mat. |
|--------|--|--------|------------------|-----------|------|
| 680758 | Barra cuadrada / Square rail | 351m | 5x5mm | Al | Alum |
| 611132 | Freno Granada / Granada control unit 1:1 | 150 u. | ⊙⊙⊙⊙⊙ max.2kg | B Gr N Bg | PA |
| 611122 | Freno Box / Box control unit 1:1 | 40 u. | ⊙-⊙-⊙ max.2kg | B | PA |
| 612450 | Guía Kurz SQ / Kurz guide SQ | 50 u. | max.5m | B | PA |
| 612470 | Guía Kurz+cordón / Kurz guide +cord | 40 u. | cord.2,5m max2kg | B | PA |
| 612330 | Guía Caché SQ / Cache SQ guide | 25 u. | max.3,5m | Tr | PC |
| 612360 | Guía Caché+cordón / Cache guide+cord | 25 u. | cord.3m max900g | Tr | PC |

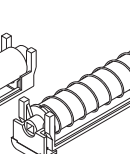
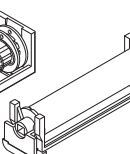
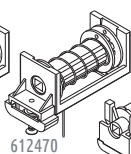
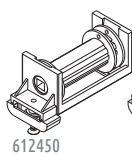

Sistema eje trébol / Clover axis system

| Ref. | Artículo / Article | Uni. | Datos / Data | Color | Mat. |
|--------|--|---------|------------------|-------|------|
| 610958 | Barra trébol / Clover rail | 438,75m | ∅6mm | Al | Alum |
| 611032 | Freno Granada TR/ Granada control unit 1:1 | 150 u. | ⊙⊙⊙⊙⊙ max.2kg | B | PA |
| 611022 | Freno Box TR / Box control unit 1:1 | 40 u. | ⊙-⊙-⊙ max.2kg | B | PA |
| 612350 | Guía Kurz TR / Kurz guide TR | 50 u. | max.5m | B | PA |
| 612370 | Guía Kurz+cordón / Kurz guide +cord | 40 u. | cord.2,5m max2kg | Tr | PA |
| 612460 | Guía Caché+cordón / Cache guide+cord | 25 u. | cord.3m max900g | Tr | PC |

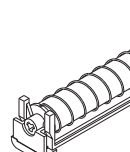
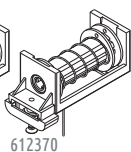
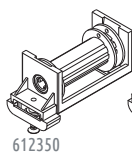
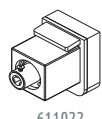
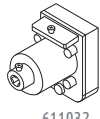
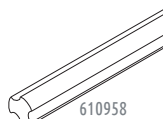

Soportes / Supports

| Ref. | Artículo / Article | Uni. | Datos / Data | Color | Mat. |
|--------|--|--------|--------------|-----------|------|
| 613062 | Soporte plástico / Plastic support | 200 u. | 25x48mm | B Gr N Bg | PA |
| 613036 | Soporte frente corto / Short front support | 100 u. | 34x27mm | Zn | Met |
| 613056 | Soporte techo / Ceiling bracket | 200 u. | 25x48mm | Zn | Met |

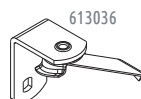

Oculto a cordón / Box rail cord system

| Ref. | Artículo / Article | Uni. | Datos / Data | Color | Mat. |
|--------|--------------------------------------|--------|--------------|-------|------|
| 611011 | Freno Cinza / Cinza cord lock | 100 u. | 24x23x18mm | Zn | Met |
| 612011 | Guía cuerda Cinza / Cinza cord guide | 250 u. | 24x23x18mm | Zn | Met |
| 614042 | Tapa Cien / Cien end cap | 300 u. | 27x33mm | B | PP |

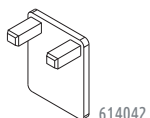
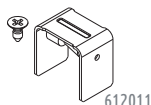
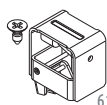

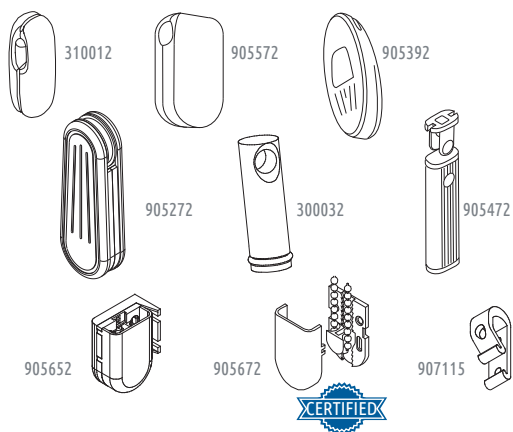

Contrapesos / Counterweights

| Ref. | Artículo / Article | Uni. | Datos / Data | Color | Mat. |
|--------|---|--------|----------------|-------------|------|
| 310012 | Contrapeso Rutroller / Rutroller count. | 60 u. | 25g Ø20x60 | B G N Bg Tr | PP |
| 905572 | Contrapeso Roma / Rome counterw. | 40 u. | 64g 59x37x20 | B | PP |
| 905392 | Contrapeso Turín / Turin counterweight | 40 u. | 48g 90x36x17 | B G N Bg | PP |
| 905272 | Contrapeso especial / Special counterw. | 32 u. | 115g 98x20x35 | B G N | PP |
| 300032 | Cont. Rutdecor / Rutdecor counterweight | 25 u. | 108g Ø20x65 | Cn Cr Gt | Met |
| 905472 | Contrapeso Sidney / Sydney counterw. | 40 u. | 110g 100x15x32 | B | ABS |
| 905652 | Tensor Lorca / Lorca taut | 50 u. | 47x22mm | B G N Bg | POM |
| 905672 | Tensor Murcia / Murcia taut | 250 u. | 47x32mm | B G N Bg | POM |
| 907115 | Tensor Yecla / Yecla taut | 100 u. | 50x20x16mm | Tr | PC |

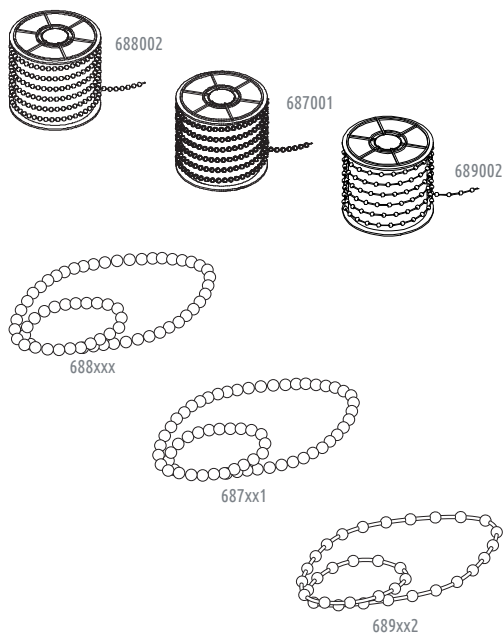

Cadenas / Chains

| Ref. | Artículo / Article | Uni. | Datos / Data | Color | Mat. |
|--------|---|------|--------------|----------|------|
| 688002 | Cadena continua / Continuous chain | 200m | Ø4,5x6mm | 8 colors | POM |
| 687001 | Cadena metálica / Metal chain | 125m | Ø4,5x6mm | Cr | Met |
| 689002 | Cadena discontinua / Discont. chain (No recomendada para frenos Granada / Not recommended for Granada control units) | 250m | Ø4,5x12mm | 8 colors | POM |

| Aros cadena continua / Continuous chain rings | 10 u. | Ø4,5x6mm | B G Bg N M Tr | POM |
|---|----------------------------|----------------------------|---------------|-----|
| 688202 - 200cm=1,00m long. | 688254 - 250cm=1,25m long. | 688302 - 300cm=1,50m long. | | |
| 688352 - 350cm=1,75m long. | 688402 - 400cm=2,00m long. | 688452 - 450cm=2,25m long. | | |
| 688502 - 500cm=2,50m long. | 688602 - 600cm=3,00m long. | | | |

| Aros cadena metálicos / Metallic chain rings | 10 u. | Ø4,5x6mm | Cr | Met |
|--|----------------------------|----------------------------|----|-----|
| 687201 - 200cm=1,00m long. | 687251 - 250cm=1,25m long. | 687301 - 300cm=1,50m long. | | |
| 687351 - 350cm=1,75m long. | 687401 - 400cm=2,00m long. | 687501 - 500cm=2,50m long. | | |

| Aros cadena discontinua / Discontinuous chain rings | 100 u. | Ø4,5x12mm | B | POM |
|---|----------------------------|----------------------------|---|-----|
| (No recomendados para frenos Granada / Not recommended for Granada control units) | | | | |
| 689202 - 200cm=1,00m long. | 689252 - 250cm=1,25m long. | 689352 - 350cm=1,75m long. | | |

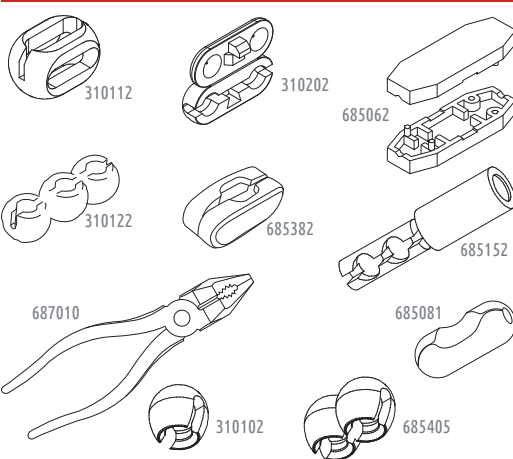

Empalmes cadena / Chain joints

| Ref. | Artículo / Article | Uni. | Datos / Data | Color | Mat. |
|--------|---------------------------------------|----------|--------------|-------------|------|
| 310112 | Empalme jaula / Cage joint | 200 u. | 8x8x12mm | 6 colors | PC |
| 310202 | Empalme cápsula / Capsule joint | 1.000 u. | Ø8x18mm | 6 colors | PP |
| 685062 | Empalme extra / Extra joint | 300 u. | 32mm | B | ABS |
| 310122 | Empalme 3 bolas / 3 Balls joint | 200 u. | Ø4,5x6mm | B G Bg N Tr | POM |
| 685382 | Empalme Castellón / Castellon joint | 100 u. | 17x7x7mm | B | PA |
| 685152 | Empalme cilindro / Cylinder joint | 500 u. | Ø4,5x18mm | B | POM |
| 687010 | Alicates para empalme / Splicing tool | 1 u. | 125x70x16mm | Zn | Met |
| 685081 | Empalme Valencia / Valencia joint | 100 u. | Ø6x13mm | Zn | Met |
| 310102 | Stopper cadena / Chain stopper | 500 u. | Ø8,5mm | B Tr | PC |
| 685405 | Empalme 2 bolas / 2 Balls joint | 200 u. | Ø8x14mm | Tr | PC |

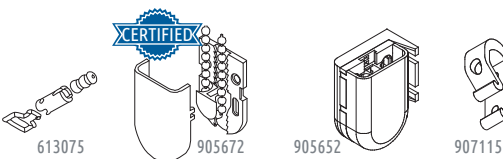

Control de tensión / Tension control

| Ref. | Artículo / Article | Uni. | Datos / Data | Color | Mat. |
|--------|-------------------------------------|--------|--------------|----------|------|
| 613075 | Clip escape cordón / Cord breakaway | 200 u. | max.4-6kg | Tr | PC |
| 905672 | Tensor Murcia / Murcia taut | 250 u. | 47x32mm | B G N Bg | POM |
| 905652 | Tensor Lorca / Lorca taut | 50 u. | 47x22mm | B G N Bg | POM |
| 907115 | Tensor Yecla / Yecla taut | 100 u. | 50x20x16mm | Tr | PC |

Varillas / Rods

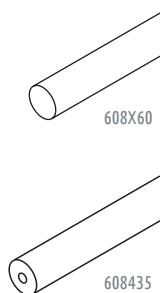

| Ref. | Artículo / Article | Uni. | Datos / Data | Color | Mat. |
|--------|--|--------|--------------|-------|------|
| 608360 | Varilla de fibra / Fibre rod | 3.000m | Ø3mm 6m | B | FV |
| 608460 | Varilla de fibra / Fibre rod | 1.200m | Ø4mm 6m | B | FV |
| 608560 | Varilla de fibra / Fibre rod | 1.800m | Ø5mm 6m | B | FV |
| 608660 | Varilla de fibra / Fibre rod | 600m | Ø6mm 6m | B | FV |
| 608860 | Varilla de fibra / Fibre rod | 1.800m | Ø8mm 6m | B | FV |
| 608060 | Varilla de fibra / Fibre rod | 300m | Ø10mm 6m | B | FV |
| 608260 | Varilla de fibra / Fibre rod | 300m | Ø12mm 6m | B | FV |
| 608435 | Varilla transparente / Transparent rod | 900m | Ø4mm 3m | Tr | PS |

Pletinas contrapeso / Bottom weight bars

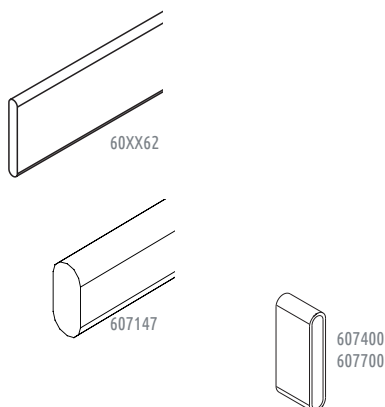

| Ref. | Artículo / Article | Uni. | Datos / Data | Color | Mat. |
|--------|--|--------|--------------|-------|------|
| 607262 | Pletina aluminio / Aluminium bottom bar | 180m | 2x25 132g/m | B An | Alum |
| 607362 | Pletina aluminio / Aluminium bottom bar | 180m | 3x20 159g/m | B An | Alum |
| 607462 | Pletina aluminio / Aluminium bottom bar | 90m | 3x25 200g/m | B An | Alum |
| 607558 | Pletina aluminio / Aluminium bottom bar | 117m | 3x30 240g/m | B An | Alum |
| 607762 | Pletina aluminio / Aluminium bottom bar | 90m | 3x40 322g/m | B | Alum |
| 607962 | Pletina aluminio / Aluminium bottom bar | 60m | 4x30 322g/m | B | Alum |
| 607862 | Pletina aluminio / Aluminium bottom bar | 60m | 4x40 427g/m | B | Alum |
| 607147 | Pletina de plástico / Plastic bottom bar | 200m | 8x18mm 4m | B | PVC |
| 607400 | Protector pletina / Bottom bar protector | 300 u. | 3x25mm | Tr | PE |
| 607700 | Protector pletina / Bottom bar protector | 300 u. | 3x40mm | Tr | PE |

Velcro / Velcro

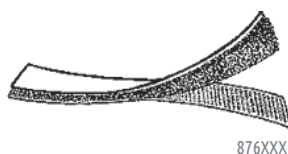

| Ref. | Artículo / Article | Uni. | Datos / Data | Color | Mat. |
|--------|-------------------------------------|------|--------------|-------|------|
| 876620 | Velcro felpa / Velcro loop | 25m | 20mm | B | PA |
| 876610 | Felpa con adhesivo / Adhesive loop | 25m | 20mm | B | PA |
| 876650 | Velour / Velour | 25m | 20mm | B | PA |
| 876920 | Velcro gancho / Velcro hook | 25m | 20mm | B | PA |
| 876910 | Gancho con adhesivo / Adhesive hook | 25m | 20mm | B | PA |

Cintas / Tapes

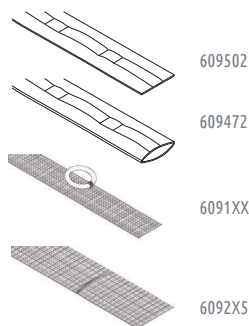

| Ref. | Artículo / Article | Uni. | Datos / Data | Color | Mat. |
|--------|--|------|--------------|---------|------|
| 609502 | Cinta VH / VH tape | 300m | 16mm | Bg B Tr | PA |
| 609472 | Cinta tubular / Tubular tape | 300m | 16mm | Bg B Tr | PA |
| 609184 | Cinta anillas Casafe / Casafe rings tape | 150m | 17mm 15cm | Tr | PA |
| 609192 | Cinta anillas Casafe / Casafe rings tape | 120m | 10mm 15cm | Tr | PA |
| 609215 | Cinta romana / Roman tape | 300m | 16mm 15cm | Tr | PA |
| 609225 | Cinta romana / Roman tape | 300m | 18mm 15cm | Tr | PA |
| 609205 | Cinta romana / Roman tape | 300m | 20mm 15cm | Tr | PA |

Cordones / Cords

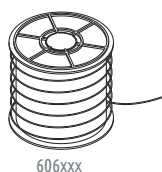

| Ref. | Artículo / Article | Uni. | Datos / Data | Color | Mat. |
|--------|--------------------|------|--------------|-------|------|
| 606100 | Cordón / Cord | 500m | Ø1,0mm | B | PET |
| 606120 | Cordón / Cord | 500m | Ø1,2mm | B | PET |
| 606140 | Cordón / Cord | 500m | Ø1,4mm | B | PET |

Control de tensión / Tension control



| | | | | | |
|--------|-------------------------------------|--------|-----------|----|----|
| 613075 | Clip escape cordón / Cord breakaway | 200 u. | max.4-6kg | Tr | PC |
|--------|-------------------------------------|--------|-----------|----|----|

Anillas y clips / Rings & clips

| Ref. | Artículo / Article | Uni. | Datos / Data | Color | Mat. |
|--------|---|----------|--------------|-------|------|
| 603105 | Anilla Ø7 / Ø7 ring | 1.500 u. | Ø7-10mm | Tr | PC |
| 603120 | Anilla Ø9 / Ø9 ring | 2.000 u. | Ø9-12mm | B Tr | POM |
| 603160 | Anilla Ø12 / Ø12 ring | 1.000 u. | Ø12-16mm | B Tr | POM |
| 603750 | Anilla pera / Pear ring | 1.000 u. | Ø13-17mm | B Tr | POM |
| 603720 | Anilla V-H / V-H ring | 2.000 u. | Ø14mm | B Tr | POM |
| 603740 | Anilla "D" / "D" ring | 3.000 u. | Ø15mm | B | POM |
| 603495 | Anilla romana / Roman ring | 1.500 u. | Ø10-17mm | Tr | PC |
| 603901 | Anilla llavero Metallica / Metal ring | 100 u. | Ø20-22mm | Zn | Met |
| 603675 | Triángulo transparente / Transp. triangle | 1.000 u. | 15x15mm | Tr | PC |
| 683142 | Clip galón o cordón / Cord or tape clip | 1.000 u. | 15x20mm | B | PA |
| 684142 | Clip Book / Book clip | 100 u. | 20x8,5mm | B | PA |
| 684132 | Clip bloqueo Toronto / Toronto clip | 200 u. | | B | POM |

Escuadras con colisos / Brackets with holes

| Ref. | Artículo / Article | Uni. | Datos / Data | Color | Mat. |
|--------|-------------------------------------|--------|--------------|-------|------|
| 834072 | Escuadra coliso / Bracket with hole | 100 u. | 75mm | B | Met |
| 834122 | Escuadra coliso / Bracket with hole | 50 u. | 125mm | B | Met |
| 834152 | Escuadra coliso / Bracket with hole | 50 u. | 150mm | B | Met |
| 834002 | Tapa-tornillos / Screws cover | 50 u. | 50x57mm | B | PP |
| 853514 | Tuerca 13x18 / 13x18 nut | 100 u. | M4 | Zn | Met |
| 821101 | Tornillo M4x10mm / M4x10mm screw | 100 u. | DIN7985 | Zn | Met |

Escuadras roscadas / Threaded brackets

| Ref. | Artículo / Article | Uni. | Datos / Data | Color | Mat. |
|--------|--|--------|--------------|-------|------|
| 832032 | Escuadra roscada / Threaded bracket | 100 u. | 3cm 1xM4 | B Zn | Met |
| 832052 | Escuadra roscada / Threaded bracket | 100 u. | 5cm 1xM4 | B Zn | Met |
| 832062 | Escuadra roscada / Threaded bracket | 100 u. | 6cm 1xM4 | B Zn | Met |
| 832082 | Escuadra roscada / Threaded bracket | 100 u. | 8cm 2xM4 | B Zn | Met |
| 832122 | Escuadra roscada / Threaded bracket | 100 u. | 12cm 3xM4 | B Zn | Met |
| 832182 | Escuadra roscada / Threaded bracket | 50 u. | 18cm 3xM4 | B Zn | Met |
| 821091 | Tornillo / screw M4x 8mm | 100 u. | DIN967 | Zn | Met |
| 831791 | Alargo soporte / Support extension | 150 u. | 22x115mm | Zn | Met |
| 831802 | Escuadra 2posic. / 2 Positions bracket | 500 u. | 50x70mm | B Zn | Met |

Tornillos / Screws

| Ref. | Artículo / Article | Uni. | Datos / Data | Color | Mat. |
|--------|-----------------------------|----------|----------------|-------|------|
| 853825 | Tornillo / Screw 4,0x30mm | 1.000 u. | DIN7505A | Zn | Met |
| 826051 | Taco Ø5 / Ø5 plug | 100 u. | Ø5x25mm | G | PA |
| 826061 | Taco Ø6 / Ø6 plug | 100 u. | Ø6x30mm | G | PA |
| 821091 | Tornillo / Screw M4x 8mm | 100 u. | DIN967 | Zn | Met |
| 821101 | Tornillo / Screw M4x10mm | 100 u. | DIN7985 | Zn | Met |
| 822011 | Tornillo+tuerca / Screw+nut | 1.000 u. | M4x12 + M4 hex | Zn | Met |